

LOCATION MAP

NOT TO SCALE

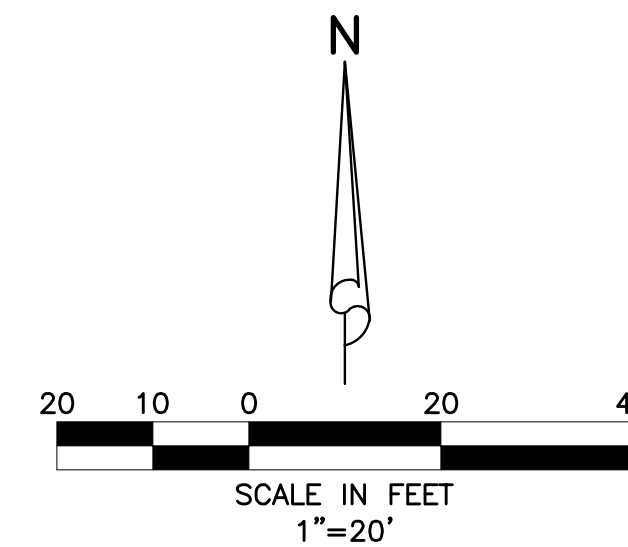

LEGEND

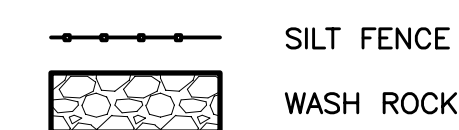

POLLUTION PREVENTION NOTES:

- 1.) THIS PLAN SHOULD BE USED AS A GUIDE, A COMPLETE STORMWATER POLLUTION PLAN SHOULD BE DEVELOPED BY THE CONTRACTOR TO MEET OR EXCEED F.D.E.P. REQUIREMENTS.
- 2.) CONTRACTOR IS RESPONSIBLE TO ENSURE THAT NO DIRT BE TRACKED OFF-SITE OR LEAVES THE SITE BY WIND, RUNOFF, OR OTHER MEANS.
- 3.) CONTRACTOR SHALL BE RESPONSIBLE FOR ALL N.P.D.E.S. REQUIREMENTS INCLUDING FILING OF N.O.I., MONITORING REPORTS AND N.O.T.
- 4.) POLLUTION PREVENTION MEASURES SHALL CONSIST OF, BUT NOT LIMITED TO, THE FOLLOWING:
 - A. CONSTRUCT WASHROCK PAD AT ALL POINTS EGRESS FOR WASHDOWN OF TRUCK TIRES.
 - B. CONSTRUCT EROSION CONTROL FENCE AND/OR TURBIDITY SCREENS ALONG PROPERTY LINES AS NEEDED.
 - C. NO AREA SHALL BE LEFT BARREN OR SUBJECT TO EROSION DURING CONSTRUCTION. SEEDING AND MULCHING IS REQUIRED FOR ANY AREAS ANTICIPATED TO BE BARREN DURING CONSTRUCTION FOR MORE THAN 15 DAYS.
 - D. TURBIDITY BARRIERS TO BE UTILIZED AT PROJECT OUTFALL.
 - E. OTHER MEASURES AS DIRECTED BY THE ENGINEER OR THE CITY OF POMPAÑO BEACH.
- 5.) IT IS THE CONTRACTORS RESPONSIBILITY TO COMPLY WITH ALL LOCAL, STATE AND FEDERAL POLLUTION PREVENTION REQUIREMENTS. FOR AFFECTED AREAS GREATER THAN 1 ACRE, COMPLIANCE SHALL INCLUDE (BUT IS NOT LIMITED TO) THE FOLLOWING:
 - A. PREPARATION OF A STORMWATER POLLUTION PREVENTION PLAN (S.W.P.P.P.) IN ACCORDANCE WITH THE D.E.P. "GENERIC PERMIT FOR STORMWATER DISCHARGE FROM LARGE AND SMALL CONSTRUCTION ACTIVITIES" (D.E.P. DOCUMENT NO. 62-621.300(4)(A)).
 - B. SUBMITTAL OF THE NOTICE OF INTENT (N.O.I.) TO THE D.E.P.
 - C. MAINTENANCE AND INSPECTION OF THE ELEMENTS OF THE S.W.P.P.P.
 - D. MAINTENANCE OF RECORDS (INSPECTION REPORTS, N.O.I., S.W.P.P.P., ETC.)
 - E. SUBMITTAL OF THE NOTICE OF TERMINATION TO THE D.E.P. AT THE CONCLUSION OF THE PROJECT.
- 6.) PROPOSED SILT FENCE (REQUIRED DURING CONSTRUCTION PER N.P.D.E.S./F.D.E.P. REGULATIONS) TO BE PLACED AS NECESSARY BY CONTRACTOR BASED ON FIELD CONDITIONS & CONSTRUCTION SEQUENCING.

48 HOURS BEFORE DIGGING
BROWARD • PALM BEACH • INDIAN RIVER
ST. LUCIE • MARTIN COUNTIES
1-800-432-4770
SUNSHINE STATE 1 CALL
UNDERGROUND UTILITIES
NOTIFICATION CENTER

NOTE: ALL ELEVATIONS SHOWN HEREON ARE RELATIVE TO THE NORTH AMERICAN VERTICAL DATUM (N.A.V.D.) OF 1988 BASED ON A SURVEY PREPARED BY BROWN & PHILLIPS, INC. (561) 615-3988.

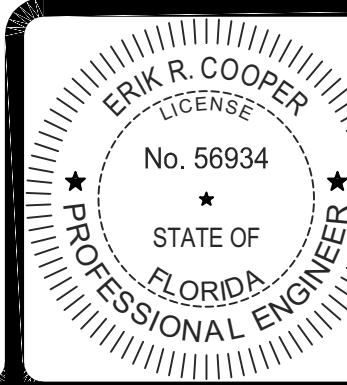

THIS ITEM HAS BEEN DIGITALLY SIGNED AND SEALED BY
ERIK R. COOPER, P.E. ON
2/23/2024.
PRINTED COPIES OF THIS DOCUMENT ARE NOT CONSIDERED SIGNED AND SEALED AND THE SIGNATURE MUST BE VERIFIED ON ANY ELECTRONIC COPIES.

REVISIONS



DESIGN	DRAWN	CHECKED	APPROVED	DATE
E.C.	B.L.			

2001 N. ANDREWS AVE
CHENEY BROTHERS • POMPAÑO BEACH
SECTION 27, TOWNSHIP 48S, RANGE 42E.
CITY OF POMPAÑO BEACH, FLORIDA
CONCEPTUAL POLLUTION
PREVENTION PLAN

JOB NO. 22-187
DRAWING NO. 22187-008
SHEET 15 OF 15
P22187-008
04/03/2024